



Vineyard Trellising Solutions

Complete trellising and anchoring solutions



- Tensioning
- Repairing
- Anchoring
- Bracing

Vineyard Trellising Solutions

As the market leader in wire joining and tensioning, Gripple is renowned for providing innovative, cost-effective solutions for trellising applications. Gripple trellising products replace traditional methods, generating time and labor savings. Our range of products work with a wide variety of wires across all types of trellising.

VIT-S
Page 7



GP No.1 & No.2
Page 5



VIT-S Kit
Page 7

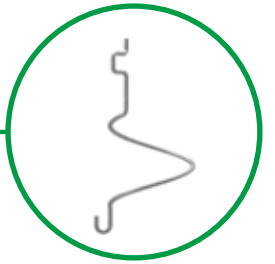

Oil Pipe Clip Kit
Page 10



Gripple Plus Range
Page 4

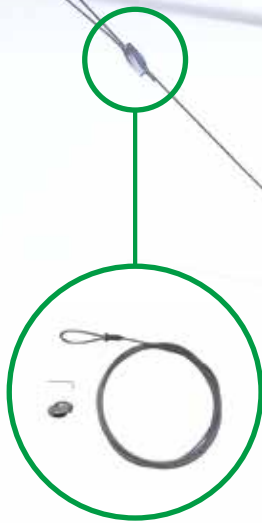

GPAK
Page 8

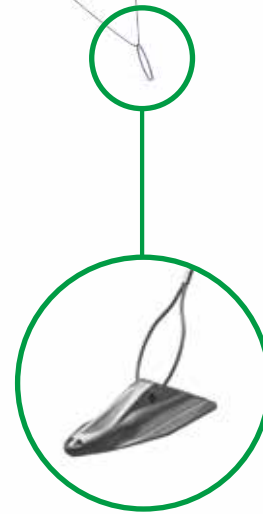

Anchor
Page 9

For tips and instructions on how to install, refer to the technical section on pages 14 & 15.

Gripple Plus Range

The Gripple Plus range of wire joiners and tensioners are suitable for all trellising applications.

- Joining and tensioning ability in one
- Eliminates tying and knotting wires, reducing installation time
- Ideal for use on high tensile and low carbon trellis wire
- Designed for high loads and corrosion resistance
- Easily re-tensioned year-after-year



Gripple Plus range of wire joiner / tensioners



Top: Wire repair using GP Medium tensioning with Torq Tool; Bottom: Standard join of trellis wire

Product	Standard Wire Gauge	Recommended Working Load
Gripple Plus Small	17 swg - 14 swg	660 lbs
Gripple Plus Medium	13.5 swg - 10 swg	880 lbs
Gripple Plus Large	10 swg - 7½ swg	1,320 lbs
Gripple Plus Jumbo	12½ swg - 10 swg	1,320 lbs

GP No. 1 & No. 2

The Gripple GP No. 1 and No. 2 are designed with a flat edge to create a stable end stop for trellises which use metal end posts

- Terminate and tension in one
- Ideal for use on steel wire and nylon monofilament
- High grade ceramic roller for corrosion resistance
- Spare integral channel allows safe tail wire return
- Tensioned using a Torq Tool and Adaptor in recessed applications



GP No.1 Installed on a metal post



Torq Tool Adaptor - Use when GP unit is installed on the inside of the post

Product	Standard Wire Gauge	Recommended Working Load
GP No. 1	15 SWG - 11 SWG	880 lbs
GP No. 2	10½ SWG - 7½ SWG	1,320 lbs

VIT-S

The Grippler VIT-S is a quick and easy way to manage your fruiting wires. VIT-S works directly with metal and wooden end posts, replacing difficult and unreliable chains.

- Replaces cumbersome chains
- Manage fruiting wires on both metal and wooden end post trellising systems
- Allows wires to be moved independently during the growing season
- Wires can be easily dropped to the ground for pruning
- Tension is easily applied by hand
- Adjustable before tensioning



VIT-S Kit - Installed on wooden post



VIT-S - Installed on metal post



VIT-S Kit - Screwed into metal post

Product	Post Type	Standard Wire Gauge	Recommended Working Load
VIT-S	Metal	17 SWG - 12½ SWG	880 lbs
VIT-S Kit	Wooden & Metal		

VIT-S can be installed directly onto metal end posts or on wooden & metal posts when bought as a kit with the VIT-S Hook.

GP Fix

GP Fix offers a simple, fast and safe solution for the quick repair of trellising wires. The innovative two-piece design pushes onto either end of a broken wire, providing extra grip and reach to reattach wires with an easy 'snap' fit.

- Simple snap fit installation ensures a quick on the spot repair
- Provides extra reach on the broken ends, reducing physical effort
- Corrosion resistant zinc alloy and ceramic rollers for long lasting repairs
- Low, smooth profile and enclosed wires, reducing the risk of catching
- Can be carried in a pocket and doesn't require extra wire
- Ideal for use with Gripple Plus Medium or GP1 when re-tensioning wire at end posts



Product	Wire Range	Ultimate Load Rating
GP Fix	1.80 - 3.20 mm	400 kg / 882 lbs
	15 - 10 SWG	

GPAK

The G Pack Bracing Kit is supplied as a ready-to-use kit comprising a pre-cut, fused length of cable and a joiner/tensioner.

- Suitable for wooden or metal post bracing
- Dual brace points for even load transfer
- Easily re-tensioned year-after-year
- Manufactured with zinc aluminum cable for corrosion resistance
- Consistent, professional finish



Installed in a loop format with choke knot on a wooden post



Installed on a metal post

Product	Cable Diameter	Cable Length	Recommended Working Load
GPAK 3	1/8 in	5 ft	880 lbs
	1/8 in	10 ft	880 lbs
	1/8 in	15 ft	880 lbs
GPAK 4	5/32 in	10 ft - 30 ft	1,320 lbs

Apex Anchor

The Grippler Anchor creates a secure, fixed anchoring point underground. No pre-digging is required, drastically reducing installation time.

- Designed for drive efficiency and maximum load capacity
- Suitable for a variety of soil types
- Quick to install
- Saves time & labor
- Ability to instantly set and load anchor



Apex Anchor 3 being driven into the ground



Installed in conjunction with a GPAK Bracing Kit

Product	Tendon Type	Cable Length
Apex Anchor 3	Wire Rope (3.00 mm / 1/8 in.)	0.9 m / 3 ft
		1.5 m / 5 ft
	Rod Tendon** (6.00 mm / 1/4 in.)	0.9 m / 3 ft
		Fiber Tendon* (4.77 mm / 3/16 in.)
Apex Anchor 4	Wire Rope (3.00 mm / 1/8 in.)	1.5 m / 5 ft
		0.9 m / 3 ft
	Rod Tendon** (6.00 mm / 1/4 in.)	0.9 m / 3 ft
		Fiber Tendon* (4.77 mm / 3/16 in.)
Apex Anchor 5	Wire Rope (8.00 mm / 5/16 in.)	1.6 m / 5.25 ft

Longevity & suitability depends on a variety of factors. Ask Grippler Technical Services for details. *Fiber Tendon Polypropylene materials are UV protected, designed for a long life. **Rod Tendon - Hot-Dipped Coating 140g/m² (19.6 microns)

For tips and instructions on how to install, refer to the technical section on pages 14 & 15.

Anchoring Tools & Accessories

Gas Powered Driver



The Gas Powered Driver provides quick installation of trellis posts and Gripple's range of anchors. Weighing only 35 lbs, it is lightweight and portable.

Drive Rod



The Drive Tool is designed specifically to work with Gripple's range of anchors. Tools are available in 4 ft. and 6 ft. lengths dependent on the depth of the ground anchor installation.

Torq Tool & Adaptor

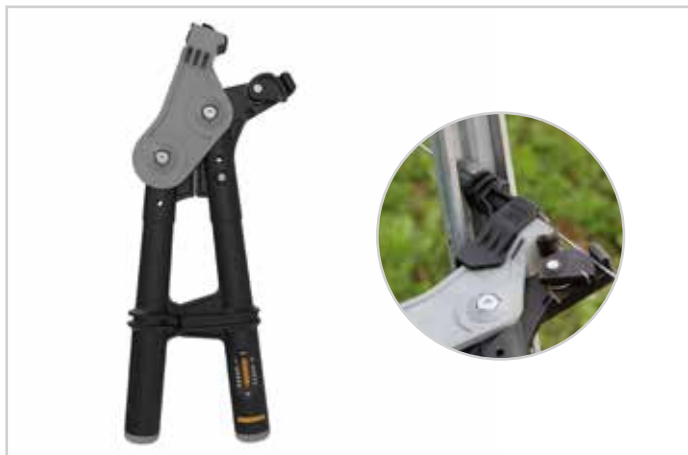

The Torq Tool is lightweight, compact, and works with all sizes of Gripple Plus joiners to tension the fence or trellis wire. Designed with a built-in gauge, the tool measures the tension you wish to apply.

With the addition of the Adaptor, the Torq Tool can be used in recessed applications - See page 5

Oil Pipe Clip Kit

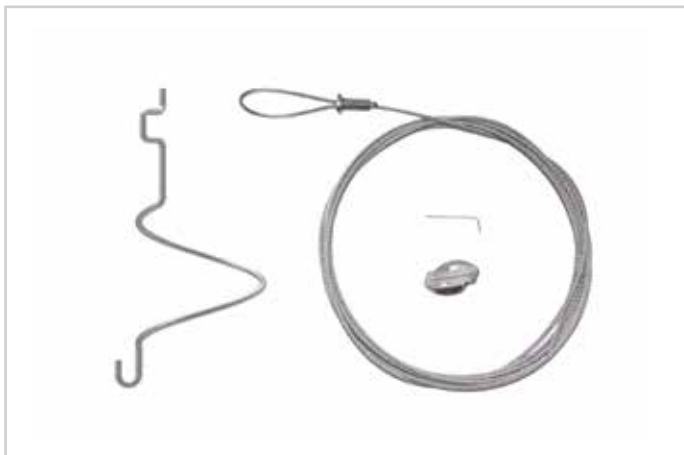

The Oil Pipe Anchor Kit (OPAK) is a simple and fast way to secure brace cables to smooth drill pipe. The OPAK eliminates the need to weld or drill onto the post. The Oil Pipe Clip holds the cinched GPAK cable at the desired height on the endpost, allowing for installation and tensioning of the brace cable with a Gripple joiner/tensioner.

Oil Pipe Clip

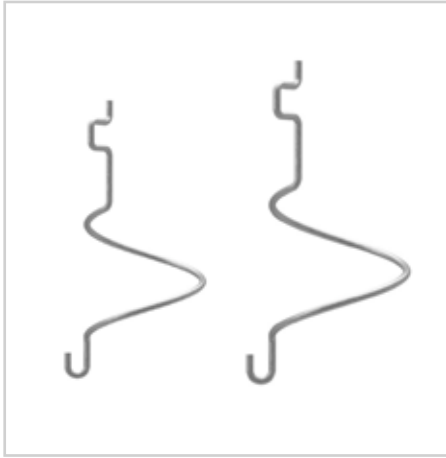

Gripple Oil Pipe Clips provide the perfect bracing solution for smooth drill pipe. This eliminates the need for on-site welding or drilling. Available in two sizes: 3 in. and 3.5 in.

VIT-S Hook

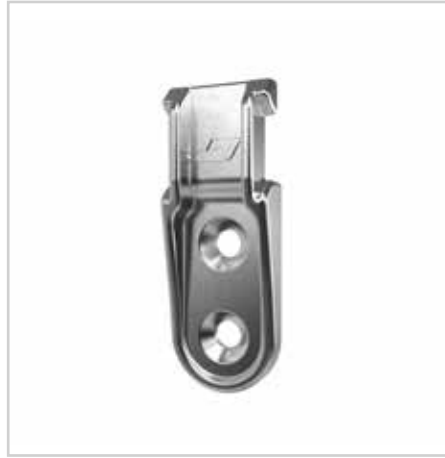

The VIT-S Hook accessory (used in conjunction with the VIT-S itself) allows for the addition of further fixing points on end posts as wires are raised through the growing season.

Twister



The Twister secures the tail wires. Making the installation completely safe and hazard free, it gives a tidy and neat finish. Use on mild steel or high tensile wire from 1/4 in. to 1/8 in.

Setting Key



The Setting Key allows Gripple tensioners to be repositioned on the wire before tension is applied. To use, simply insert the key into the small hole adjacent to the main channel, releasing the roller and allowing the tensioner to move freely.

Work Belt



The Gripple Work Belt is the perfect accessory for carrying Gripple products and vineyard tools.

Wire & Cable Cutters



Wire Cutters are suitable for cutting high tensile wire, and are available in Small (for 3/16" diameter wire) and Large (for up to 1/4" diameter).

The non-slip handles make them easy to use and the hardened steel jaws deliver great results.

Find your solution

Use our guide to match your wire with the correct Gripple product.

Wire Type	Wire Range	Gripple Plus Small	Gripple Plus Medium	Gripple Plus Large	Gripple Plus Jumbo	VIT-S
Join, Tension & Repair	17 SWG - 14 SWG	✓				
	17 SWG - 12½ SWG					✓
	15 SWG - 11 SWG					
	14 SWG - 10 SWG		✓			
	12½ SWG - 10 SWG					✓
	12½ SWG - 10 SWG				✓	
	10 SWG - 7½ SWG				✓	
Bracing	1/8 in. x 15 ft.		✓			
	5/32 in. x 15 ft. - 30 ft.			✓		
Anchoring	1/8 in. x 3 ft.					
	5/16 in. x 3 ft.					



GP No. 1	GP No. 2	GPAK 3*	GPAK 4*	Apex 3	Apex 4	Apex 5	Maximum Working Load
							660 lbs
							880 lbs
✓							880 lbs
							880 lbs
							1,320 lbs
	✓						1,320 lbs
							1,320 lbs
✓		✓					880 lbs
	✓		✓				1,320 lbs
				✓	✓		**Dependant on soil type
						✓	**Dependant on soil type

* Combine with the same sized Anchor for a complete anchoring solution that's simple and fast to install.

** Dependant on soil type and conditions. Please contact Gripple Sales Advisor for more information.

Recommendations are based on typical installations. Longer rows, heavy crops or exposed areas may require a different product. Seek advice first.

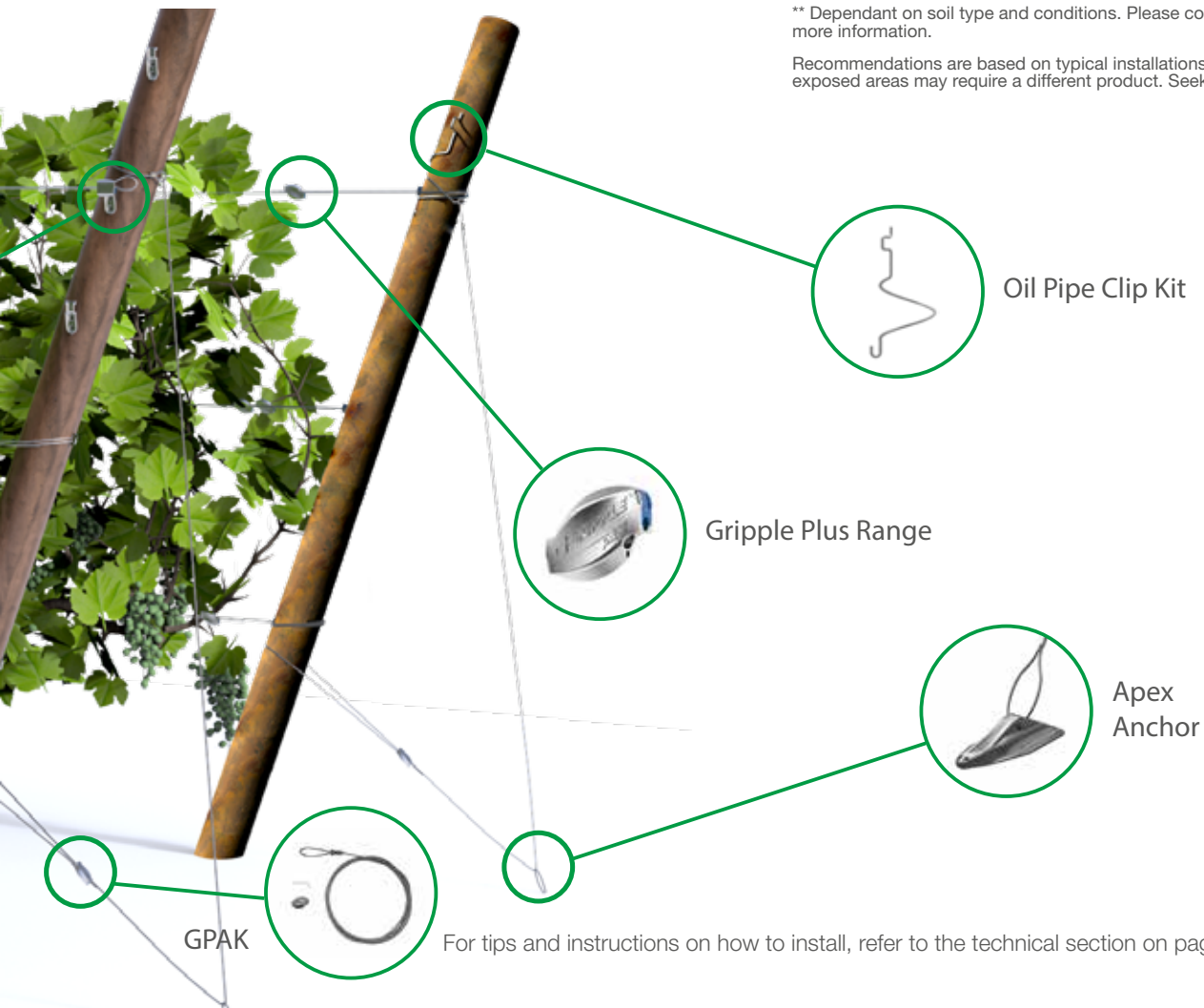

For tips and instructions on how to install, refer to the technical section on pages 14 & 15.

Technical Advice & Installation

Gripple Plus range - Installation (featuring Setting Key adjustment)

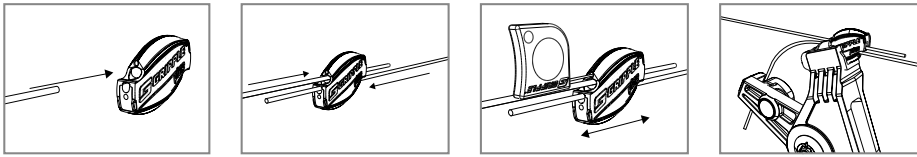

- Apply and re-apply tension with a Gripple Tensioning Tool (leave at least 3 in. tail wire)
- Reposition before applying tension using a Setting Key

VIT-S - Installation

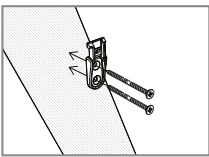

For Installation of the VIT-S Kit on wooden & metal posts; Install the VIT-S Hook before continuing...

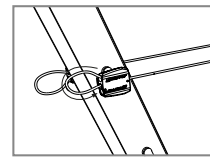
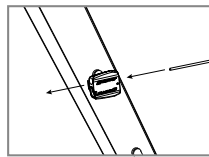
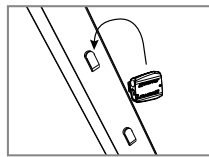

- Loop the tail wire back into the unit to provide a safe, neat finish
- Install additional VIT-S Hooks to allow positioning up and down the post

GP No. 1 & No. 2 - Installation

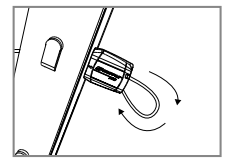
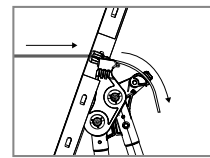
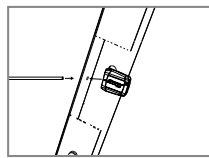
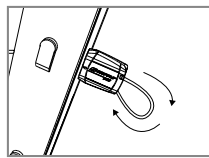
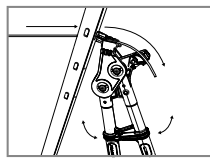
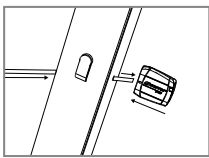

- If the post is installed 'open-side-out', there is a handy adaptor that can be fitted to the Tensioning Tool to make tensioning easier

Adaptor (inside metal post)

Twister - Installation

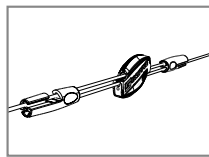
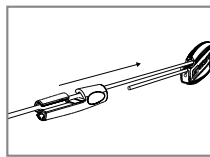
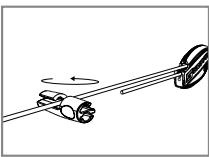

- A Twister tidies tail wires and can be removed and re-attached to allow for re-tensioning

Anchor - Installation

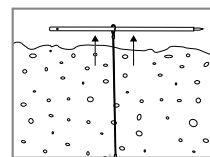
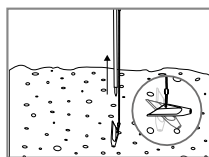
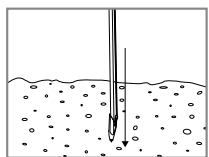
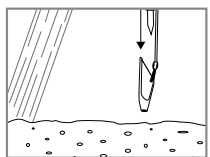
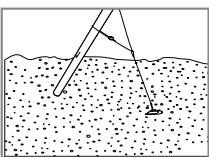

- Always drive the Anchor fully into the ground, to a depth of at least 3 ft.
- For even quicker installation of Gripple's Anchors, use the Gas Powered Driver

Oil Pipe Clip - Installation

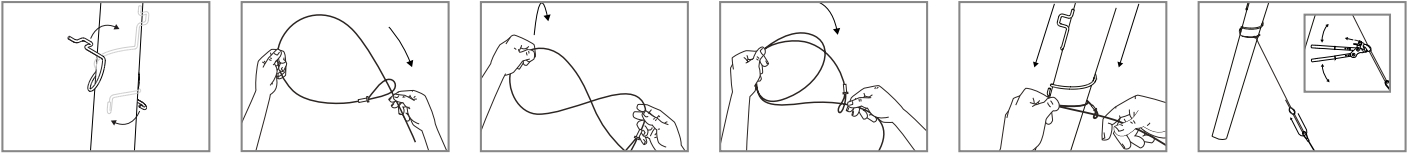

- Never tension above the wire manufacturer's recommendation

GPAK - Loop Installation

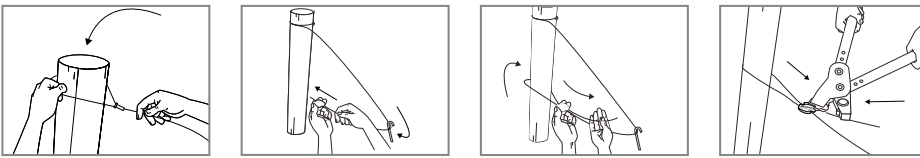

- Never tension above the wire manufacturer's recommendation

GPAK - Wood Post (Cinch)

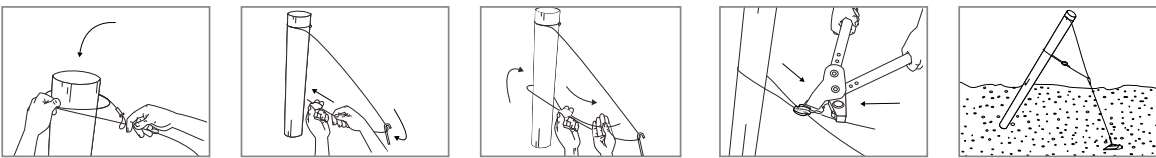

- Combine with an Anchor for a complete anchoring solution that's simple and fast to install.

GPAK - Metal Post (End Stop)

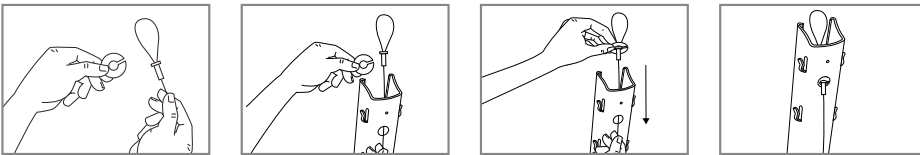

- Combine with an Anchor for a complete anchoring solution that's simple and fast to install.

www.gripple.com
grippleinc@gripple.com

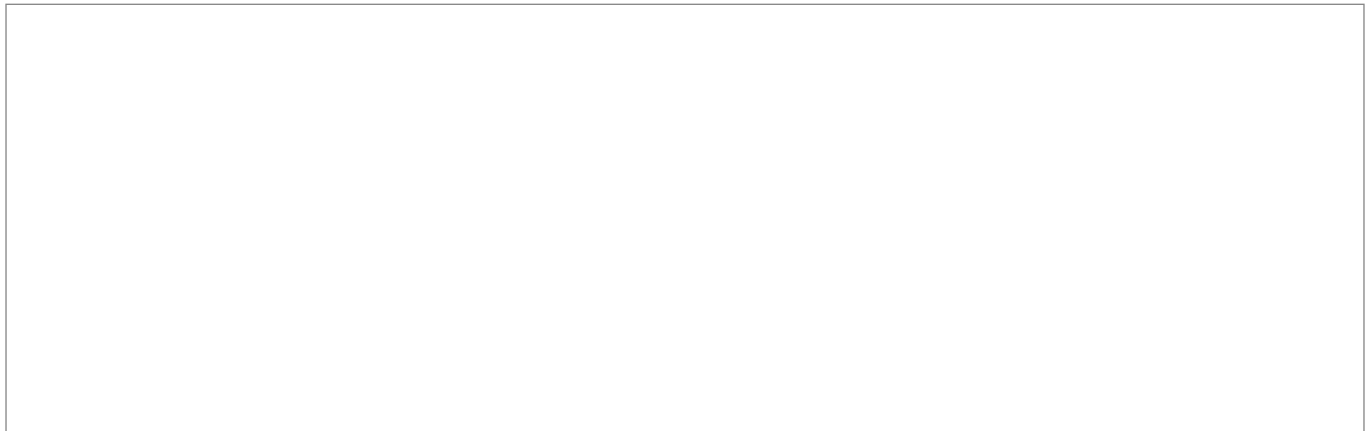

Gripple Inc

1611 Emily Lane
Aurora
Illinois 60502
USA

T | +1 866 474 7753
F | +1 800 654 0689
E | grippleinc@gripple.com

Gripple Canada Inc

6665 Tomken Road
Unit 9-10 Mississauga
Ontario L5T 2C4
Canada

T | +1 905 458 8700
F | +1 800 654 0689
E | CAinfo@gripple.com

Gripple Ltd (Headquarters)

The Old West Gun Works
Savile Street East
Sheffield S4 7UQ
UK

T | +44 (0) 800 018 4264
F | +44 (0) 114 275 1155
E | info@gripple.com

Gripple Europe SARL

1, rue du commerce
BP 37
67211 Obernai Cedex
France

T | +33 (0)3 88 95 44 95
F | +33 (0)3 88 95 08 78
E | frinfo@gripple.com

Gripple India

B 95/2
Naraina Industrial Area
Phase I
New Delhi-110028

T | +91 11-40582703
F | +91 11-40582703
E | ininfo@gripple.com

BROC-VIN-US

Published Jan 2021

Please refer to www.gripple.com for the most up to date user advice and product information.

WE ARE SOCIAL
FOLLOW OUR UPDATES



© 2019 Gripple

Gripple is a registered trademark of Gripple Limited.

Company registered in England No. 1772901, VAT Reg No. GB 600 1951 88